

CONFIGURING DEVICE

For configuration parameters explanation and device configuration over phone please read **Voice Fax User's manual**.

INDICATION

For status indication please read **Voice Fax User's manual**.



This sign on the package means that it is necessary to read the User's Manual before you start using the device.



This sign on the package means that all used electronic and electric equipment should not be mixed with general household waste.

Voice Fax device has been tested with following fax devices:

Samsung SCX-4216F which is a member of group SCX-xxxxx.

Panasonic KX-FT938, KX-FC258, KX-FP343 which are members of groups KX-FPxxx, KX-FCxxx, KX-FTxxx.

Philips Magic 3-2 Primo and Magic 3-2 Colour Dect which are members of group Magic 3-2.

Canon MF5770, FAX-B820 which are members of groups Mfxxxx and FAX-B8xxx.

List of tested fax devices is continuously supplemented.

For complete list of fax device models please apply to your local distributor or representative.

Other product and company names mentioned herein may be trademarks or tradenames of their respective owners.



Equipment:	GSM Voice Fax Gateway
Model Number:	TVF200

Are in conformity with the following EC Directives, including all amendments:

RoHS

R&TTE Directive 1999/5/EC

LVD Directive 2006/95/EC

EMC Directive 2004/108/EC

RoHS 2011/65/EU

Note. Please visit our web site www.teltonika.eu for complete user manual.
www.teltonika.eu -> Products -> TVF200 -> User Manual

FINAL REMARKS

For more detailed information about the device, please read the documentation which is found on our web site (www.teltonika.eu). If you encounter any problems using the device and you are not able to solve them yourself, please contact our Customer Service Centre at support@teltonika.eu. We will be glad to help you!



VOICE FAX GATEWAY QUICK START GUIDE

Thank you for purchasing our device! We hope it will satisfy your expectations and you will enjoy its particular features. Please, find few minutes to read the Quick Start Guide before starting the work. It will make the installation and usage of the device easier.

INTRODUCTION

Voice Fax device is created correspondingly to up-to-date telecommunications and electronic technologies. The Voice Fax emulates the line. Facsimile messages and/or phone calls in GSM network can be sent and received using analogue fax and/or phone connected to the device. Voice Fax device gives a user exclusive possibility to change parameters of the device with ordinary telephone using Voice Fax Service menu.

PACKAGE CONTENTS

- Cardboard box.
- Voice Fax Gateway device.
- AC/DC power supply adapter.
- External GSM antenna.
- Quick Start Guide (this document).

Note: the manufacturer does not provide a SIM card among other items of the package, which is necessary for connection to GSM network! You can obtain a SIM card from your local GSM service provider!

i HOW TO START?

Before powering on the device make sure:

- SIM card is inserted (Step 1)
- Antenna is connected (step 2)
- External fax device or telephone is connected to the „PHONE“ or „FAX“ socket (Step 3 and Step 4)
- Power supply connector is inserted into „DC“ socket (Step 5)

When the device is set to work, that is, SIM card inserted, antenna, external fax device connected to line and power supply are connected, the Power LED lights on. The startup can take up to 20 seconds (it is recommended to wait). During that time, the module checks the SIM card, detects the appropriate GSM network and checks the working parameters.

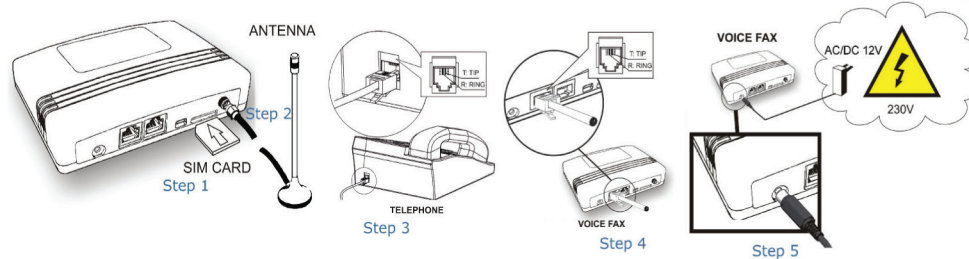

Note. Pick up the handset and enter PIN code if PIN code request is active on the SIM card.

i SENDING FAX

After everything is connected correctly insert sheets You want to send into externally connected fax device. Before dialing number please make sure that fax device is connected to „FAX“ socket.

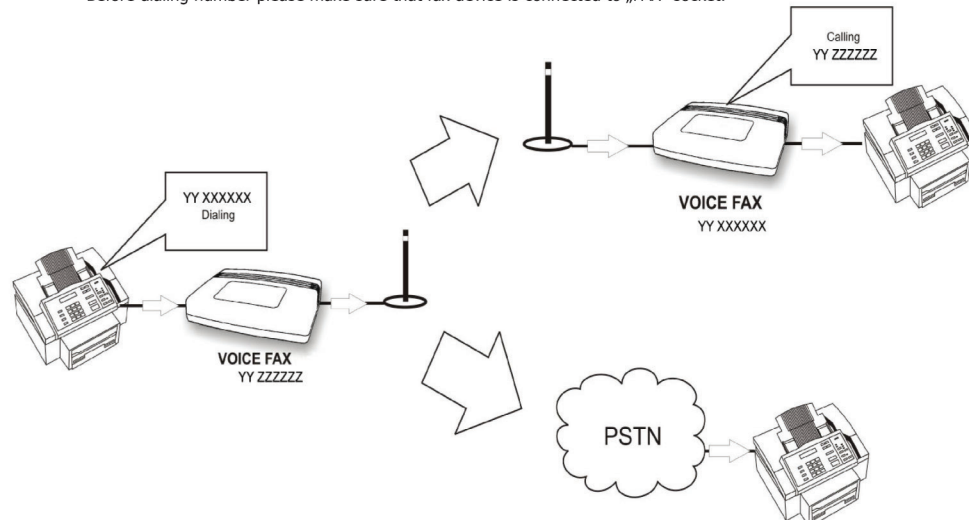

i RECEIVING FAX

If incoming call is fax call the device will answer automatically as fax device. Note that SIM card must support fax service.

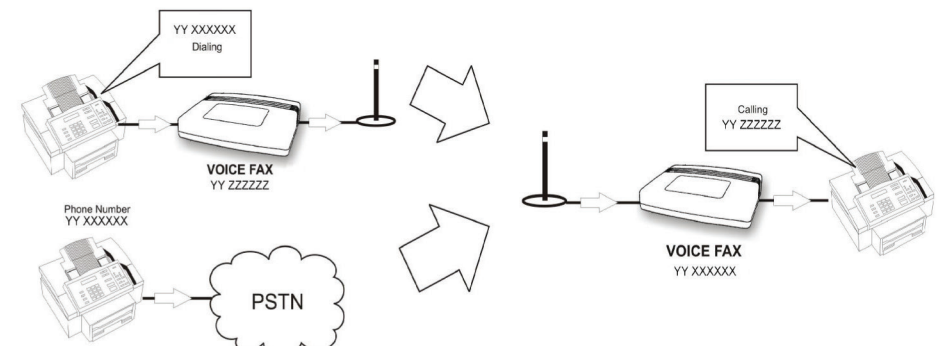

i MAKING VOICE CALL

After everything is connected correctly and device is ready to work please make sure that phone is connected to „PHONE“ socket, pick up the handset and dial number.

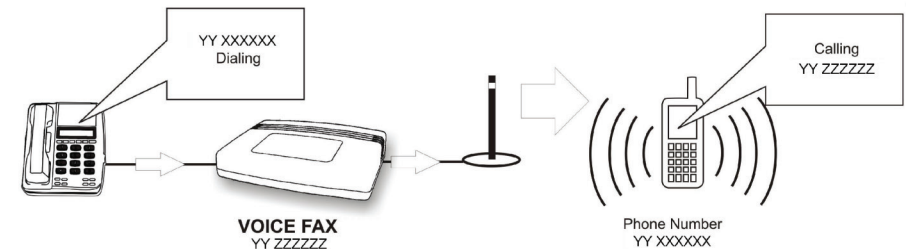

i RECEIVING VOICE CALL

If local fax machine or phone is connected to „PHONE“ or „FAX“ socket after incoming voice call phone will start ringing automatically.

